

KEY TO DEMISE

Tenant B demise (not Casino space)

KEY TO WORKS

Existing structure/fitting retained.

New element.

NOTE:

This drawing has been prepared from existing unchecked survey information provided by the client. All dimensions are to be checked on site and any discrepancies reported to the designer prior to proceeding. Figured dimensions where given are to take precedence over scaled or site dimensions.

The layout/design proposals indicated in this drawing have been developed by Steelman Partners and this drawing is for execution and co-ordination purposes only.

0M 1 2 3 4 5 6 7 8 9 10

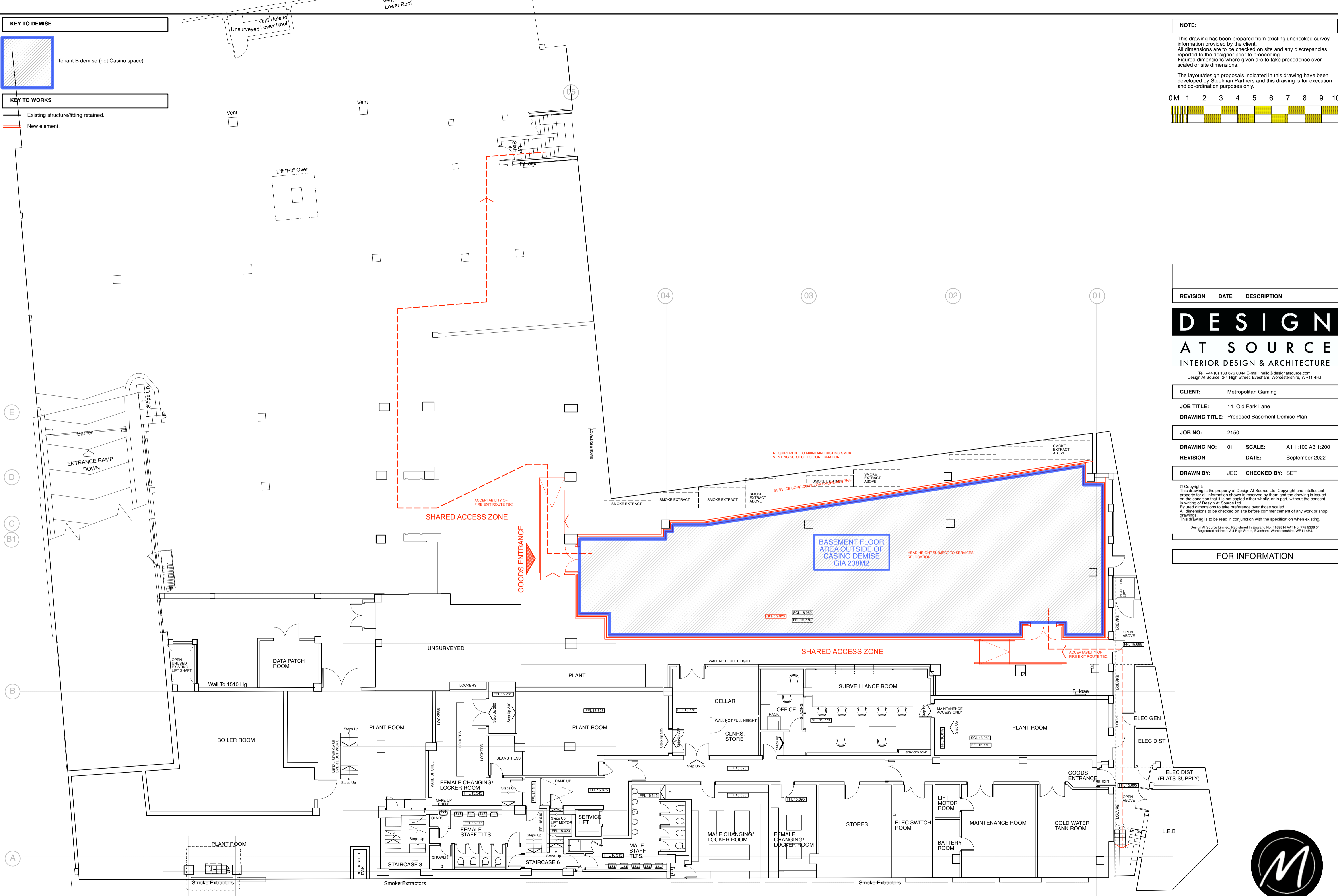

REVISION	DATE	DESCRIPTION
DESIGN		
AT SOURCE		
INTERIOR DESIGN & ARCHITECTURE		
<small>Tel: +44 (0) 138 676 0044 E-mail: hello@designatsource.com Design At Source, 2-4 High Street, Evesham, Worcestershire, WR11 4HJ</small>		
CLIENT:	Metropolitan Gaming	
JOB TITLE:	14, Old Park Lane	
DRAWING TITLE:	Proposed Basement Demise Plan	
JOB NO:	2150	
DRAWING NO:	01	SCALE: A1 1:100 A3 1:200
REVISION	DATE:	September 2022
DRAWN BY:	JEG	CHECKED BY: SET

© Copyright: This drawing is the property of Design At Source Ltd. Copyright and intellectual property for all information shown is reserved by them and the drawing is issued on the condition that it is not copied either wholly, or in part, without the consent in writing of Design At Source Ltd. Figured dimensions to take preference over those scaled. All dimensions to be checked on site before commencement of any work or shop drawings. This drawing is to be read in conjunction with the specification when existing.

Design At Source Limited, Registered in England No. 4186514 VAT No. 775 5396 01 Registered address: 2-4 High Street, Evesham, Worcestershire, WR11 4HJ.

FOR INFORMATION

14 OLD PARK LANE
PROPOSED BASEMENT DEMISE PLAN



KEY TO DEMISE

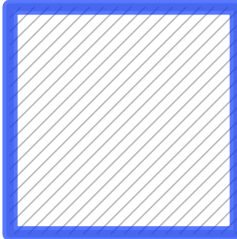

Tenant B demise (not Casino space)

KEY TO WORKS

- Existing structure/fitting retained.
- New element.

NOTE:

This drawing has been prepared from existing unchecked survey information provided by the client. All dimensions are to be checked on site and any discrepancies reported to the designer prior to proceeding. Figured dimensions where given are to take precedence over scaled or site dimensions.

The layout/design proposals indicated in this drawing have been developed by Steelman Partners and this drawing is for execution and co-ordination purposes only.

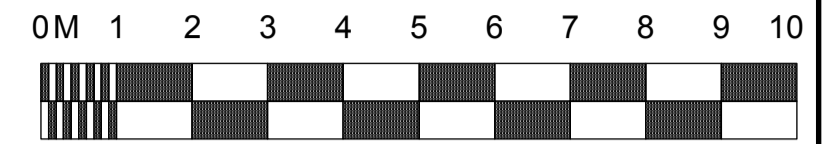

E
D
C
B1
B
A

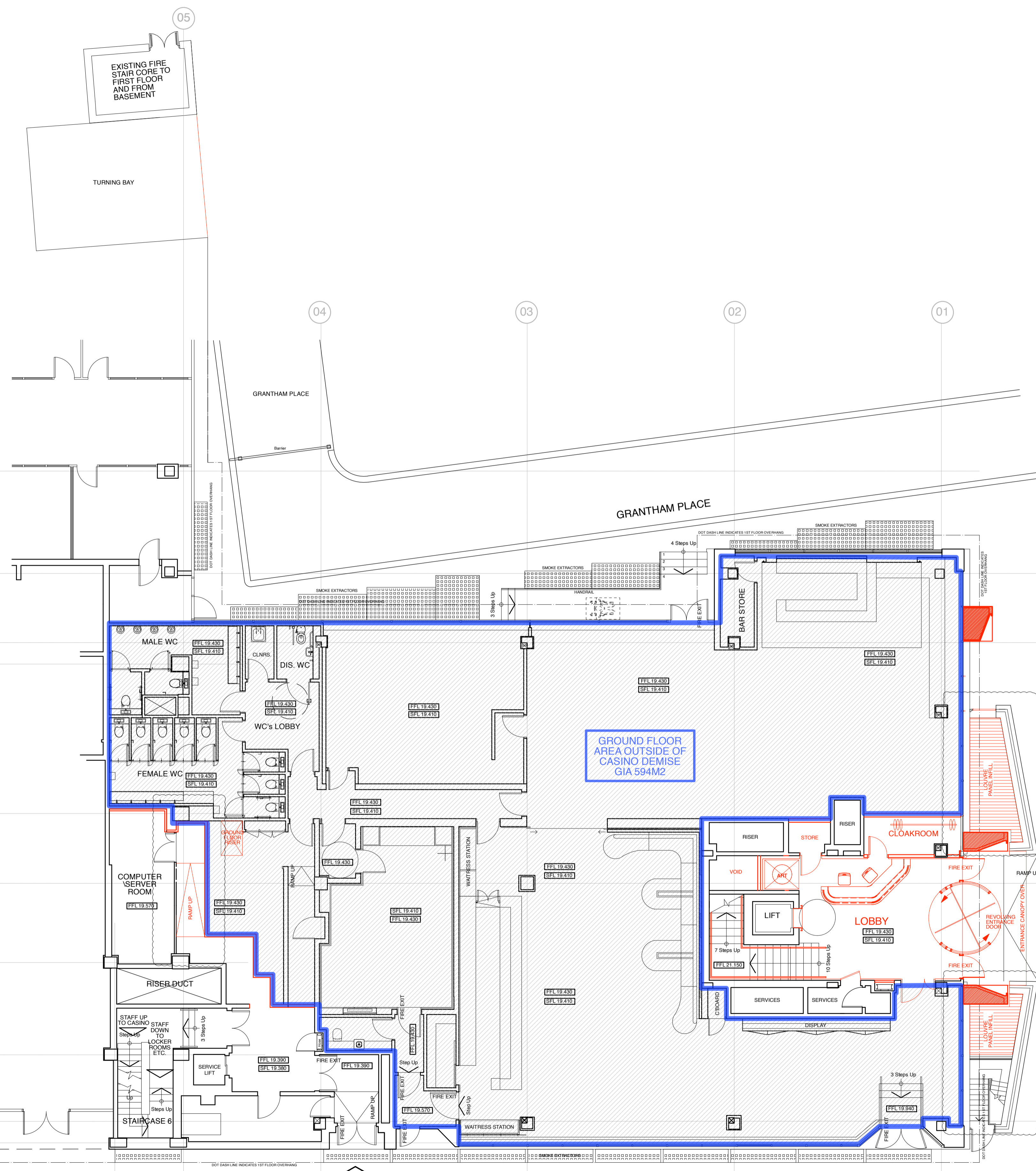

A 22 Sept 2022 Adjust demise line "as built".

REVISION	DATE	DESCRIPTION
A	22 Sept 2022	Adjust demise line "as built".

DESIGN AT SOURCE
INTERIOR DESIGN & ARCHITECTURE

Tel: +44 (0) 138 676 0044 E-mail: hello@designatsource.com
Design At Source, 2-4 High Street, Evesham, Worcestershire, WR11 4HJ

CLIENT: Metropolitan Gaming

JOB TITLE: 14, Old Park Lane

DRAWING TITLE: Proposed Ground Floor Demise Plan

JOB NO: 2150

DRAWING NO: 02 SCALE: A1 1:100 A3 1:200

REVISION A DATE: September 2022

DRAWN BY: JEG CHECKED BY: AGB

© Copyright:
This drawing is the property of Design At Source Ltd. Copyright and intellectual property for all information shown is reserved by them and the drawing is issued on the condition that it is not copied either wholly, or in part, without the consent in writing of Design At Source Ltd.
Figured dimensions to take preference over those scaled.
All dimensions to be checked on site before commencement of any work or shop drawings.
This drawing is to be read in conjunction with the specification when existing.
Design At Source Limited, Registered in England No. 4186514 VAT No. 775 5396 01
Registered address: 2-4 High Street, Evesham, Worcestershire, WR11 4HJ.

FOR INFORMATION

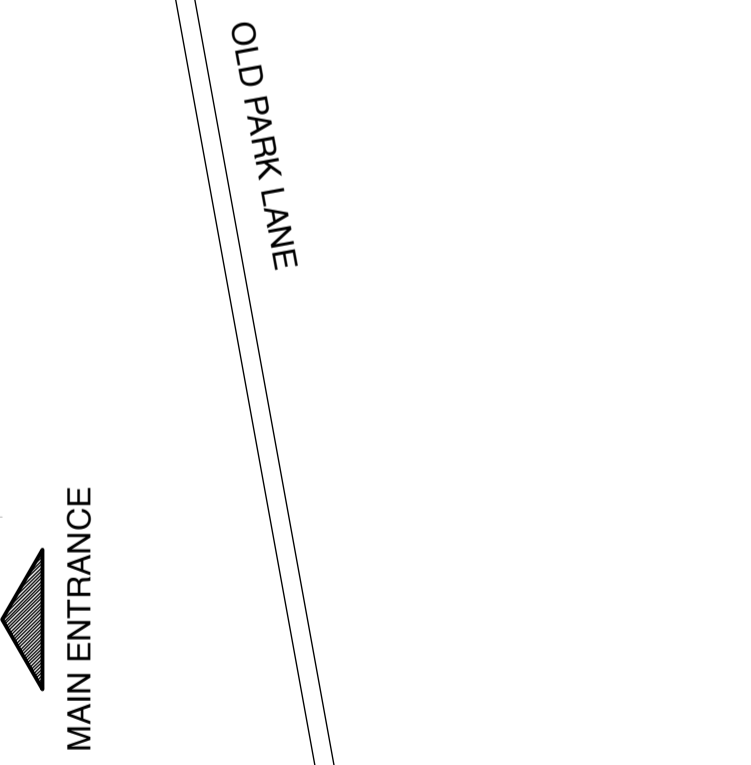

14 OLD PARK LANE
PROPOSED GROUND DEMISE PLAN

